

CTB-H1 Series

CTB-H1 series current transformer is compact, smaller than other models with the current ratio of the transformer is small, clamshell-style terminal cover is well protected by the second terminal. With related accessories you can use Din rail mounting, a current from 5A to 3000A

◆ **Features**

- Safe, easy to install, portable
- Wide inner window, allowing clamping of big cables or bus-bars
- Wide range of sizes to accommodate all the existing installations

◆ **Applications**

- Current measurement, monitoring and protection for electrical wiring and equipment.
- Current and power measurement for electric motors, lighting, air compressor, heating and ventilation system, air-condition equipment and automation – control system.
- Current, power and energy monitoring device.
- Relay protection device.

◆ **Circuit connection diagram**

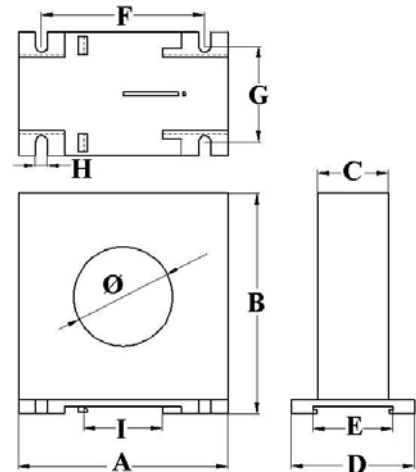
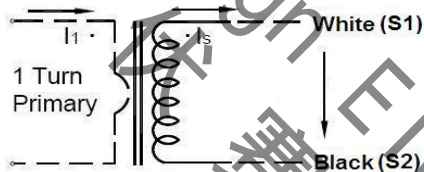

◆ **Technique Index**

Electrical Parameter	
Frequency	50-400Hz
Rated Input	5A-3000A
Measuring range	5%In-130%In
Rated Output	0-5A
Ratio	≤ ± 0.5%
Phase angle	≤ ±30min
Dielectric strength	2.5KV/1mA/1min
Insulation Resistance	DC500V/100MΩ min

Mechanical Parameter	
Case	PC /UL94-V0
Bobbin	PBT
Core	Silicon steel
Internal structure	Epoxy
Construction	Screw
Operating Temp	-25°C ~ +75°C
Operating Humidity	≤85%
Output Connection	Terminal

◆ **Type Selection** (Output: 1A/5A/mV)

Mfg P/N	Rated Input (A)	Output (A)	Accuracy	Dimensions(mm/inch)									
				Ø	A	B	C	D	E	F	G	H	I
CTB-H1-45	5-400A	1A/5A	0.5、1.0	45	96	100	32	56	36	74	43	5	35
CTB-H1-65	50-1500A	1A/5A	0.5、1.0	65	115	120	32	56	36	88	43	5	35
CTB-H1-80	100-2000A	1A/5A	0.5、1.0	80	130	135	32	56	36	109	43	5	35
CTB-H1-100	100-3000A	1A/5A	0.5、1.0	100	150	155	32	56	36	129	43	5	35