

PEE, PEI & FEY TYPE CORES

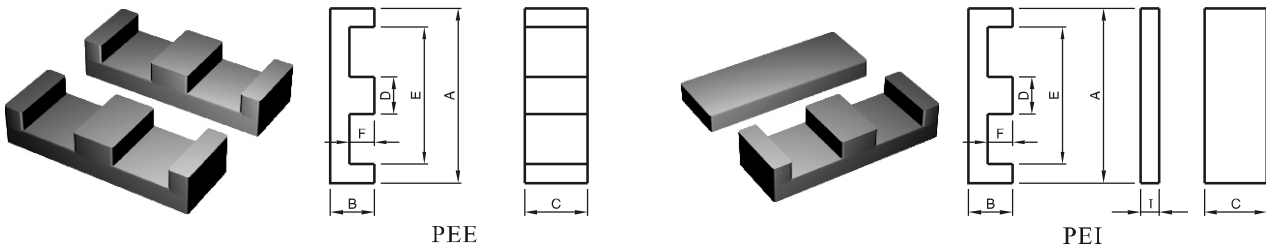

PEE & PEI TYPE CORES (MATERIALS):P1,P2,P3

Dimensions

CORES TYPE	Dimensions(mm)						
	A	B	C	D	E	F	I
PEE58	58.42±1.17	10.54±0.20	38.10±0.78	8.10±0.20	50.39min	6.35min	
PEI 58	58.42±1.17	10.54±0.20	38.10±0.78	8.10±0.20	50.39min	6.35min	4.04±0.12
PEE64	64.00±0.76	10.20±0.10	50.80±0.81	10.16±0.18	53.16min	5.03min	
PEI 64	64.00±0.76	10.20±0.10	50.80±0.81	10.16±0.18	53.16min	5.03min	5.08±0.13

Effective parameter

CORES TYPE	Effective parameter					
	C1(mm ³)	Le(mm)	Ae(mm ²)	Ve(mm ³)	Wt(g/set)	AL±25% μ H/N ²
PEE58	0.270	81.2	301	24600	130.00	7546(P3)
PEI 58	0.224	68.3	305	20829	110.00	8844(P3)
PEE64	0.155	80.2	516	41400	210.00	13020(P3)
PEI 64	0.137	69.9	511	35539	181.00	14565(P3)

FEY TYPE CORES (MATERIALS):P3

Dimensions & Effective parameter

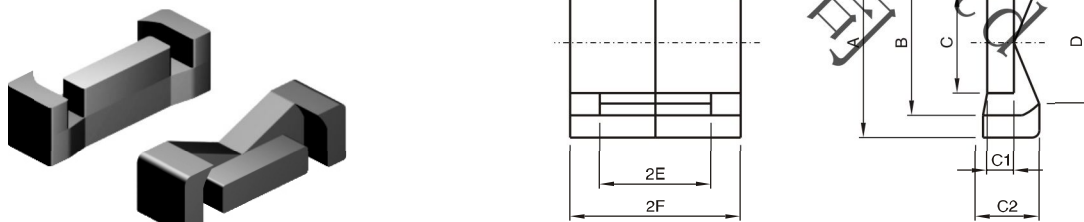

FEY

CORES TYPE	Dimensions(mm)								Effective parameter AL±30%	Weight (g)
	A	B	C	C1	C2	D	E	F		
FEY12.8	12.8±0.2	9.8±0.25	6.8-0.2	1.5-0.2	3.8-0.2	8.8+0.3	3.75+0.2	5.75±0.1	900	1.8
FEY15.3	15.3-0.6	11.8+0.5	8.0-0.2	1.7-0.2	3.8-0.2	11.0+0.5	4.4+0.2	6.5±0.1	950	2.8