

THROUGH-HOLE RADIAL ENCAPSULATED POWER INDUCTOR

LGB 1112C-1315C SERIES

FEATURES:

- Plastic housing
- Water proof structure Ferrite Core
- Excellent Mechanical Strength
- Excellent Solderability
- High Reliability

OPTIONS:

- Packaging:Tape & Reel is standard (Qty:2000pcs)
- Bulk packaging available for smaller quantities
- Tolerance:10% and 5% is standard, tighter tolerances available

COMMON APPLICATIONS:

- VCRs, PDP, LCD, TV set
- Automotive Systems
- Computer Peripheral Equipment
- GPS, DC/DC convertor, XDSL Modem
- Electronic Games
- Communications Equipment
- General Electronic Applications

ELECTRICAL CHARACTERISTICS:

Part Number	L μ H	Test Freq KHz	DCR Ω Max	IDC Max A	Part Number	L μ H	Test Freq KHz	DCR Ω Max	IDC Max A
LGB1112C-3R3M	3.30	1	0.010	5.90	LGB1315C-100M	10	1	0.023	5.10
LGB1112C-4R7M	4.70	1	0.015	4.80	LGB1315C-150M	15	1	0.028	4.50
LGB1112C-6R8M	6.80	1	0.016	4.60	LGB1315C-220M	22	1	0.035	4.20
LGB1112C-100M	10	1	0.025	3.70	LGB1315C-330M	33	1	0.043	3.70
LGB1112C-150M	15	1	0.029	3.40	LGB1315C-470M	47	1	0.052	3.40
LGB1112C-220M	22	1	0.040	2.90	LGB1315C-680M	68	1	0.068	3.00
LGB1112C-330M	33	1	0.062	2.30	LGB1315C-101K	100	1	0.097	2.50
LGB1112C-470M	47	1	0.075	2.10	LGB1315C-151K	150	1	0.140	2.10
LGB1112C-680M	68	1	0.130	1.60	LGB1315C-221K	220	1	0.200	1.70
LGB1112C-101K	100	1	0.160	1.40	LGB1315C-331K	330	1	0.300	1.40
LGB1112C-151K	150	1	0.260	1.10	LGB1315C-471K	470	1	0.430	1.10
LGB1112C-221K	220	1	0.360	1.00	LGB1315C-681K	680	1	0.610	0.99
LGB1112C-331K	330	1	0.520	0.82	LGB1315C-102K	1000	1	1.000	0.78
LGB1112C-471K	470	1	0.660	0.72	LGB1315C-152K	1500	1	1.300	0.68
LGB1112C-681K	680	1	1.100	0.56	LGB1315C-222K	2200	1	2.000	0.55
LGB1112C-102K	1000	1	1.400	0.50	LGB1315C-332K	3300	1	3.100	0.44
LGB1112C-152K	1500	1	2.400	0.38	LGB1315C-472K	4700	1	4.400	0.37
LGB1112C-222K	2200	1	3.200	0.33	LGB1315C-682K	6800	1	6.500	0.30
LGB1112C-332K	3300	1	4.900	0.26	LGB1315C-103K	10000	1	10.00	0.24
LGB1112C-472K	4700	1	7.600	0.21					
LGB1112C-682K	6800	1	9.800	0.18					
LGB1112C-103K	10000	1	18.00	0.14					
LGB1112C-153K	15000	1	24.00	0.12					

Note:1. K= ± 10%,M= ± 20%,N= ± 30%

TECHNICAL INFORMATION:

- IDC Max:Determined when superimposed
 - Testing: (Equivalent acceptable) Inductance:HP4284A
RDC:QuadTech 1880 Milliohm meter
Q- HP4342A - SRF-HP4191A
DC current is decreased 10% against its initial value
 - Operating temperature: -40°C to +105°C
 - Storage Temperature: -40°C to +105°C
 - Solder methods: Vapor Phase,Infrared Reflow
 - Resistance to soldering heat:260°C for 10 seconds
 - Solvent resistance: Conforms to MIL-STD-202E
 - Marking: Inductance & Tolerance
- Note:All specifications subject to change without notice.

PHYSICAL CHARACTERISTICS:

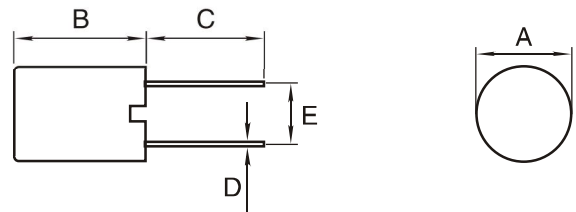

DIMENSIONS IN:mm

Part number	A	B	C	D	E
LGB1112C	11.5Max	12.5Max	5.0Min	0.6	5.0
LGB1315C	14.0Max	17.0Max	5.0Min	0.6	5.0